



Dell Thunderbolt Dock (TB16) information and specifications

This article provides features and specification information for the Dell Thunderbolt Dock TB16.

Dell Thunderbolt Dock TB16.



Features of Dell Thunderbolt Dock

The Dell Thunderbolt Dock (TB16) is a device that links all your electronic devices to your laptop computer using Thunderbolt™ 3 (Type-C) cable interface. When you connect the laptop to the docking station, you can gain access to all your peripherals such as the mouse, keyboard, stereo speakers, external hard drive, and large-screen displays without having to plug each one into the laptop.

Key Features:

- Supports up to three FHD displays or two 4K displays @ 60Hz.

i Note: Precision 7510 / 7710 / 7520 / 7720 systems with discrete graphics and the Switchable Graphics option disabled in the BIOS can support more than 3 displays. Reference [Help Me Choose: Graphics Card](https://www.dell.com/learn/help-me-choose/hmc-precision-graphics-card?ref=CFG) ([//www.dell.com/learn/help-me-choose/hmc-precision-graphics-card?ref=CFG](https://www.dell.com/learn/help-me-choose/hmc-precision-graphics-card?ref=CFG)) under Features & Benefits.

- Supports faster data transfer of up to 40 Gbps, ideal for large files.
- Common docking experience across platforms with Thunderbolt port(s) having data, video, and power capabilities.
- Single cable for power and data (up to 130w on supported computers only).

For more information about USB Type-C, refer to the knowledgebase article [USB Type-C - Frequently Asked Questions](https://www.dell.com/support/article/SLN296825/en) ([//www.dell.com/support/article/SLN296825/en](https://www.dell.com/support/article/SLN296825/en)).

i Note: Dell recommends that you update the docking station drivers. Browse to [Drivers & Downloads](https://www.dell.com/support/home/product-support/product/dell-thunderbolt-dock-tb16/drivers) ([//www.dell.com/support/home/product-support/product/dell-thunderbolt-dock-tb16/drivers](https://www.dell.com/support/home/product-support/product/dell-thunderbolt-dock-tb16/drivers)) page to find the drivers for Dell Thunderbolt Dock TB16. Please also note that Diagnostic tests will not identify issues with the dock should you encounter any issues as these are designed to test the connected system only.

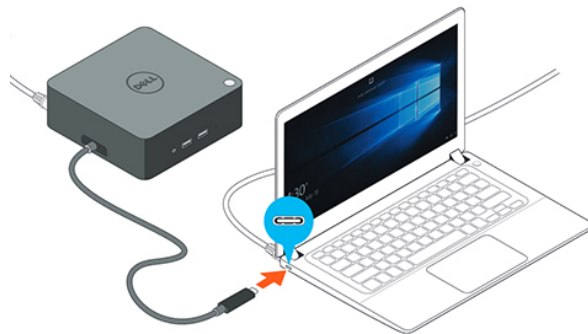

1. HDMI
2. VGA
3. Mini-DisplayPort (mDP)
4. DisplayPort (DP)
5. Ethernet RJ-45 with LEDs
6. USB 2.0 (x2)
7. USB 3.0
8. Thunderbolt ¹ (USB Type-C)
9. 7.4 mm DC-in Power Input
10. Speaker Out
11. Dell Docking Station Connector
12. Global 3.5 mm Headset Jack
13. USB 3.0 with PowerShare
14. USB 3.0

15. Power Adapter LED
16. Dock Button
17. Kensington Lock Slot

Connecting the Dell Thunderbolt Dock TB16 to your computer.

Dell Thunderbolt Dock (TB16)	
Display Ports	VGA, mDP, HDMI, DP, Thunderbolt
Number Displays Supported	3 @ 60Hz ⁴
Max Resolution	5120 x 2880 @ 60Hz
USB Ports	USB 2.0 - (2), USB 3.0 - (3)
Thunderbolt 3 Port	USB Type-C
Audio/Headphone	3.5 mm Combo - (1), 3.5 mm Speaker Out (1)
Network	RJ-45 Gigabit Ethernet
LED Indicators	Power Adapter LED
	Docking Cable Connector LED
	RJ-45 LEDs
Dock Connector	Proprietary Docking Connector to USB Type-C
AC Adapter	180W/240W
Dimensions	145 x 145 x 52 mm
	5.7 x 5.7 x 2.05 inches
Weight	1.63 lbs
	740 g
System Requirements	PC equipped with DisplayPort over USB-C or Thunderbolt
Operating Systems	Windows 7/8/8.1/10
Systems Management ²	Wireless vPro supported by the notebook, tablet, or workstation
Docking Cable Type	USB Type-C Thunderbolt (0.5m)
MAC Address ³	Pass Thru MAC Address (Dell Systems ONLY)
Warranty	If purchased as a tied laptop accessory the dock shares the system warranty
	If purchased APOS, 1 yr warranty. Advanced Exchange (DAO/APJ), Next business day exchange EMEA
¹ USB-Type C Non-Thunderbolt™ or USB Type-C Universal cable required. The host device must support Thunderbolt™ 3 for Thunderbolt speeds to be supported on the Dell Thunderbolt™ Dock. ² Dell Dock and Dell TBT Dock do not support wired vPro. If vPro is needed, the host Ethernet port can be used, or WiFi vPro within the host. ³ The dock will pass through the NB/Tablet MAC address ⁴ With Intel HD Integrated graphics. Some systems with Discrete Graphics (NVIDIA/AMD) may be able to display additional displays, but due to bandwidth limitations of the Thunderbolt bus, the refresh rate may have to be reduced to 30 Hz. See the TB16 user guide pg 22 (http://downloads.dell.com/manuals/all-products/esuprt_electronics/esuprt_docking_stations/dell-thunderbolt-dock-tb16_user%27s%20guide_en-us.pdf)	

System Compatibility Matrix for the TB16

	Model	AC Adapter Wattage Required
Latitude	Latitude 12 7000 7275	180
	Latitude 13 7000 7370	180
	Latitude 15 5000 E5x70 w/H CPU w/Discrete Graphics	240
	Latitude 12 7280 w/vPro	180
	Latitude 14 7480 w/vPro	180
	Latitude 15 5580 w/H CPU w/Discrete Graphics	240
	Latitude 15 5480 w/H CPU w/Discrete Graphics	240
Precision	Precision 15 3520	240
	Precision 15 5520	240
	Precision 17 7710 (requires system power adapter for charging)	240
	Precision 15 7510 (requires system power adapter for charging)	240
	Precision 17 7720 (requires system power adapter for charging)	240
	Precision 15 7520 (requires system power adapter for charging)	240
	Precision 15 3510	240
	Precision 15 3520	240
	Precision 15 5510	240
	Precision 15 5520	240
XPS	XPS 12 9250	180
	XPS 13 9360	180
	XPS 13 9365 2-in-1	180
	XPS 13 9350	180
	XPS 15 9550	240
	XPS 15 9560	240

Note: Ensure the latest BIOS revision available is installed before connecting to these docks.

Note: The Precision 15 7000 and Precision 17 7000 series require AC power adapters connected to both the system and the TB16 dock.

Resolution Support Table (Intel HD Integrated Graphics)

Dell Thunderbolt Dock TB16		
Resolutions	Number of Displays	Refresh Rate
1920 x 1080	3	60 Hz

1920 x 1200	3	60 Hz
2048 x 1356	3	60 Hz
2560 x 1080	3	60 Hz
2560 x 1440	3	60 Hz
2560 x 1600	3	60 Hz
3440 x 1440	2	60 Hz
3840 x 2160	2	60 Hz
5120 x 2880	1	60 Hz

[Back to Top](#)

Article ID: SLN301105

Last Date Modified: 09/25/2017 07:52 AM